

— Route Alignment
 — Existing A66
 [Red Outline] Order Limits
 [Dashed Orange] Study Area 100m
 [Dashed Green] Study Area 250m
 [Green Square] Camera Trap
 [Blue Line] Watercourses
 [Purple Line] Mammal Riparian Walking Transect Routes
 RCT: Riparian Camera Trap
 CT: Camera Trap

Camera Trap Sightings
 [Green Circle] Otter
 [Pink Circle] Otter Cubs
 [Yellow Circle] Otter Holt
 [Brown Triangle] Water Vole
 [Green Triangle] Otter
 [Brown Triangle] Feeding Stations/Signs
 [Orange Circle] Other

Incidental Records
 [Brown Triangle] Water Vole
 [Green Triangle] Otter
 [Brown Triangle] Feeding Stations/Signs
 [Orange Circle] Other

Otter Field Signs
 [Green Circle] Feeding Signs
 [Star] Footprints
 [Green Diamond] Unconfirmed Holt/Resting Place
 [Green Circle] Other
 [Green Square] Paths
 [Green Plus] Sightings
 [Green Circle] Slides
 [Green Square] Spraint

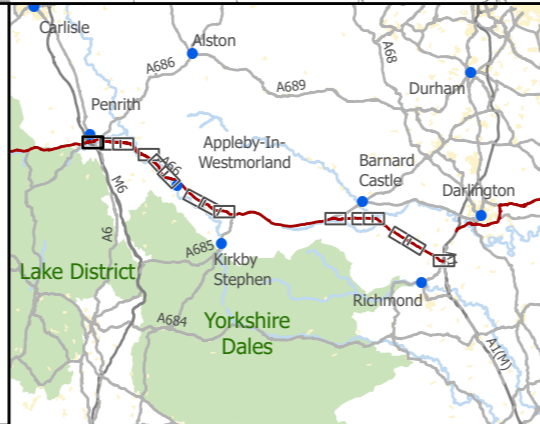

national highways
 3 Piccadilly Place
 Manchester
 M1 3BN

P02	First Issue				
	EREI	CESL	HWHI	AMIT	KWHA
	23/03/22	17/04/22	22/04/22	22/04/22	22/04/22
Revision	Created	Checked	Reviewed	Approved	Authorised

Scale @ A3: 1:10,000 | Project Ref No HE565627 | Stage: Stage 3
 © Crown copyright and database rights (2022). All rights reserved. OS 100030649.
 Contains public sector information licensed under the Open Government Licence v3.0.

Project Name
 A66 Northern Trans-Pennine Project

Map Title
 Figure 6.16
 Otter and Water Vole Survey

Scheme: 0102, M6 Junction 40 to Kemplay Bank
Sheet 1 of 15

Map Number	Project	Originator	Volume
HE565627	-	AMY	- EBD
S00	-	MP	- LB - 003165
Location		Type	Role
Suitability	S4	FIT FOR STAGE APPROVAL	Revision
			P02

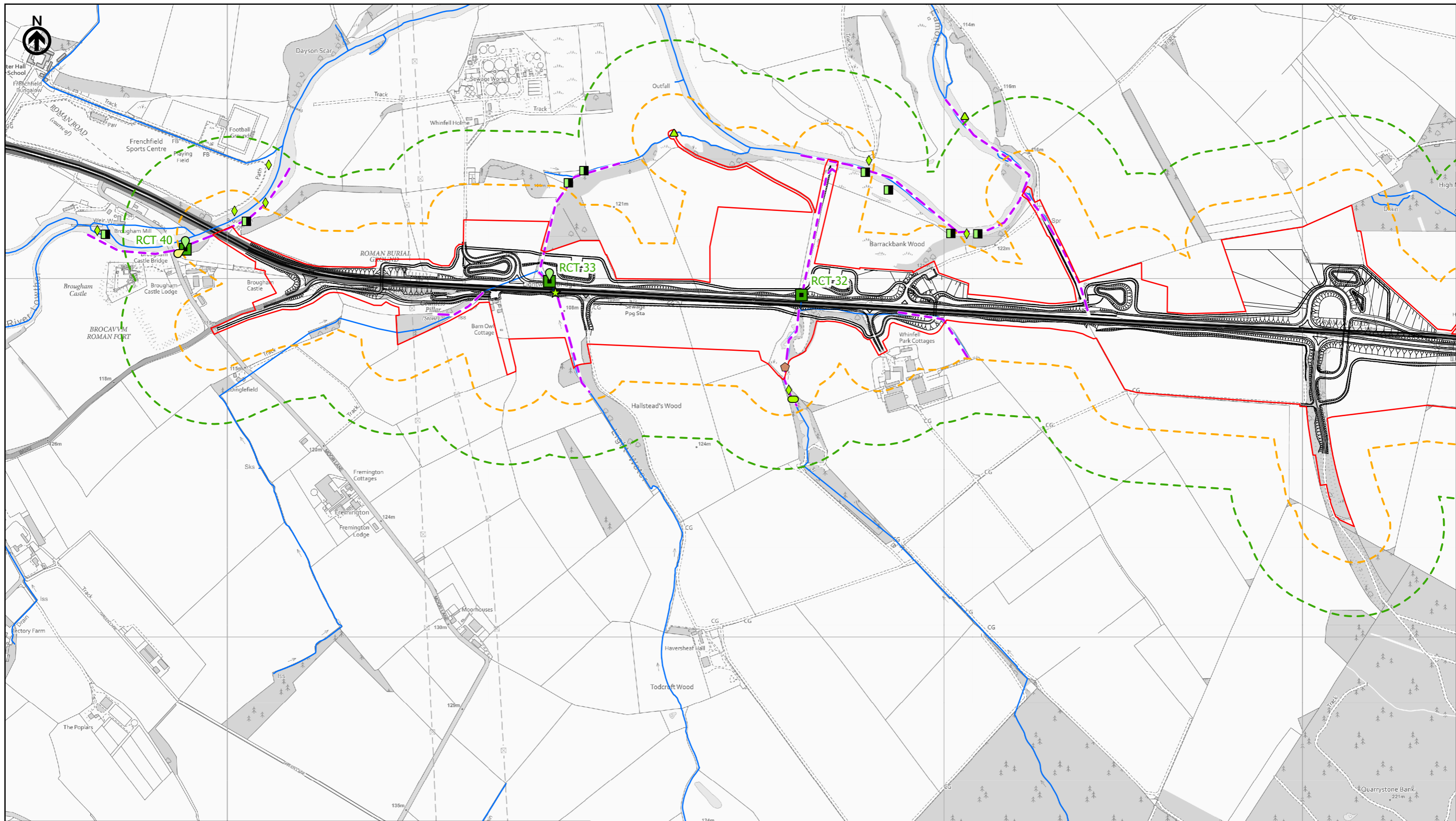

<ul style="list-style-type: none"> — Route Alignment — Existing A66 — Order Limits — Study Area 100m — Study Area 250m ■ Camera Trap — Watercourses — Mammal Riparian Walking Transect Routes 	<p>Camera Trap Sightings</p> <ul style="list-style-type: none"> ● Otter ● Otter Cubs ● Otter Holt <p>Incidental Records</p> <ul style="list-style-type: none"> ● Water Vole ● Otter <p>Water Vole Field Signs</p> <ul style="list-style-type: none"> ● Feeding Stations/Signs ● Other 	<p>Otter Field Signs</p> <ul style="list-style-type: none"> ● Feeding Signs ● Footprints ● Unconfirmed Holt/Resting Place ● Other ● Paths ● Sightings ● Slides ● Spraint
---	---	---

RCT: Riparian Camera Trap
CT: Camera Trap

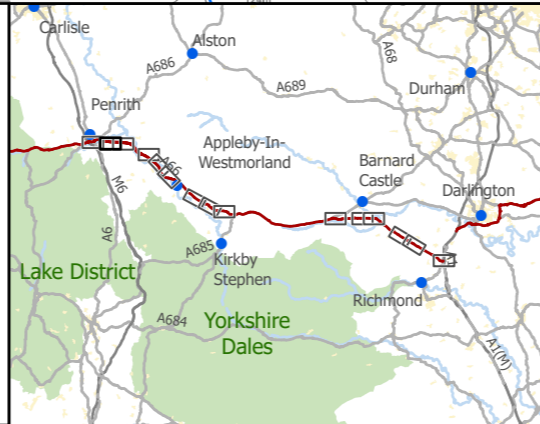

national highways

3 Piccadilly Place
Manchester
M1 3BN

P02	First Issue				
	EREI	CESL	HWHI	AMIT	KWHA
	23/03/22	17/04/22	22/04/22	22/04/22	22/04/22
Revision	Created	Checked	Reviewed	Approved	Authorised

Kilometres
0 0.25 0.5

Scale @ A3: 1:10,000 | Project Ref No HE565627 | Stage: Stage 3
© Crown copyright and database rights (2022). All rights reserved. OS 100030649.
Contains public sector information licensed under the Open Government Licence v3.0.

Project Name
A66 Northern Trans-Pennine Project

Map Title
Figure 6.16

Scheme: 03, Penrith to Temple Sowerby
Sheet 2 of 15

Map Number	Project	Originator	Volume
HE565627	-	AMY	- EBD
S00	-	MP - LB	- 003167
Location	Type	Role	Number
S4	FIT FOR STAGE APPROVAL		P02

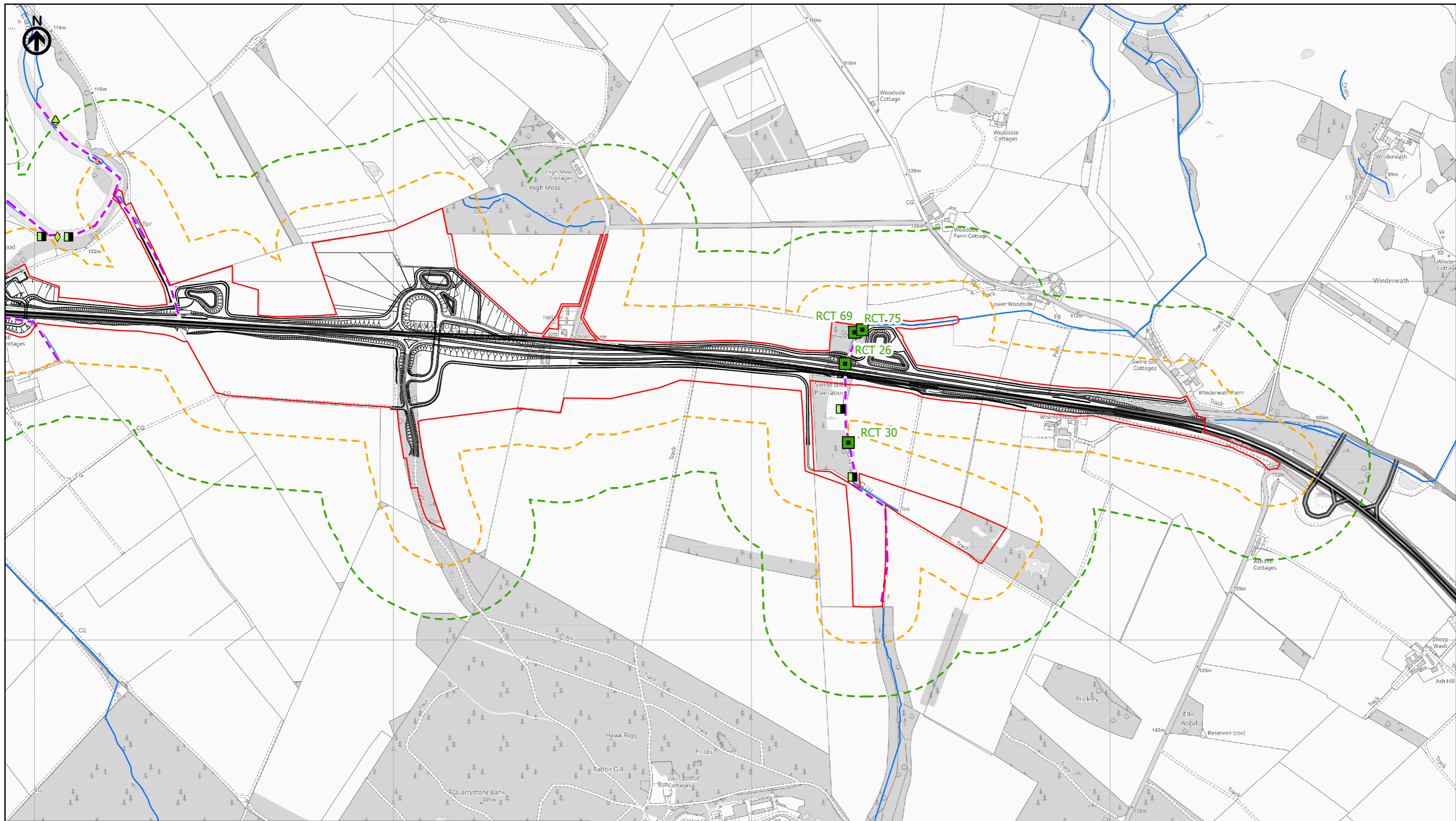

<ul style="list-style-type: none"> Route Alignment Existing A66 Order Limits Study Area 100m Study Area 250m Camera Trap Watercourses Mammal Riparian Walking Transect Routes 	<p>Camera Trap Sightings</p> <ul style="list-style-type: none"> Otter Otter Cubs Otter Holt <p>Incidental Records</p> <ul style="list-style-type: none"> Water Vole Otter <p>Water Vole Field Signs</p> <ul style="list-style-type: none"> Feeding Stations/Signs Other 	<p>Otter Field Signs</p> <ul style="list-style-type: none"> Feeding Signs Footprints Unconfirmed Holt/Resting Place Other Paths Sightings Slides Spraint
---	---	---

RCT: Riparian Camera Trap
CT: Camera Trap

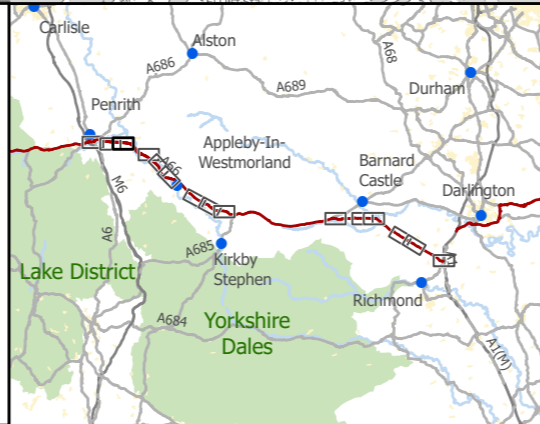

national highways

3 Piccadilly Place
Manchester
M1 3BN

P02	First Issue				
	EREI	CESL	HWHI	AMIT	KWHA
	23/03/22	17/04/22	22/04/22	22/04/22	22/04/22
Revision	Created	Checked	Reviewed	Approved	Authorised

Kilometres
0 0.25 0.5

Scale @ A3: 1:10,000 | Project Ref No HE565627 | Stage: Stage 3
© Crown copyright and database rights (2022). All rights reserved. OS 100030649.
Contains public sector information licensed under the Open Government Licence v3.0.

Project Name A66 Northern Trans-Pennine Project			
Map Title Figure 6.16			
Scheme: 03, Penrith to Temple Sowerby			
Sheet 3 of 15			
Map Number Project	Originator	Volume	
HE565627	AMY	EBD	
S00		MP	LB - 003168
Location		Type	Role
Suitability S4	Suitability Description FIT FOR STAGE APPROVAL		Revision P02

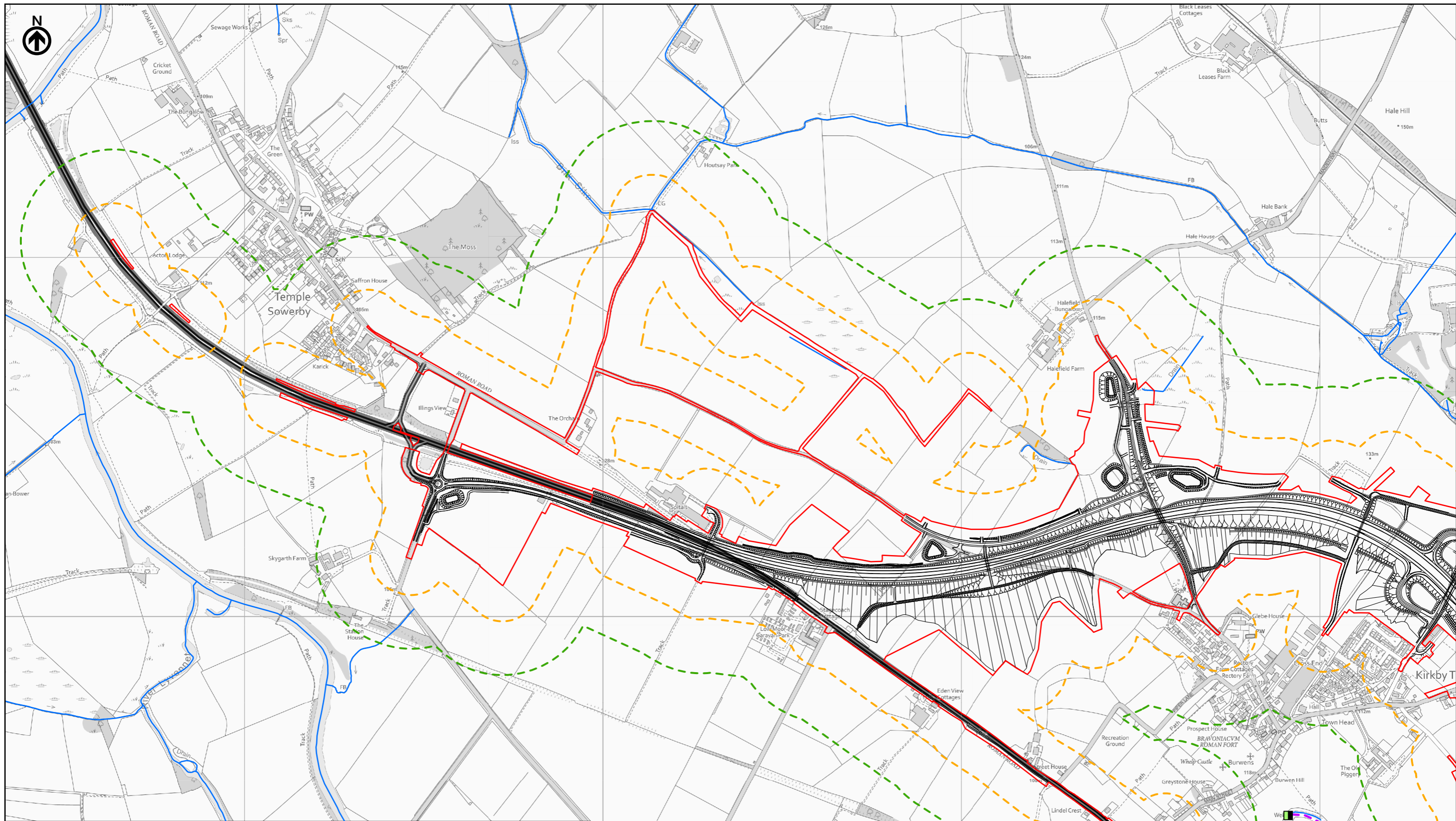

<ul style="list-style-type: none"> — Route Alignment — Existing A66 — Order Limits - - - Study Area 100m - - - Study Area 250m ■ Camera Trap — Watercourses — Mammal Riparian Walking Transect Routes 	<p>Camera Trap Sightings</p> <ul style="list-style-type: none"> ● Otter ● Otter Cubs ● Otter Holt <p>Incidental Records</p> <ul style="list-style-type: none"> ▲ Water Vole ▲ Otter <p>Water Vole Field Signs</p> <ul style="list-style-type: none"> ● Feeding Stations/Signs ● Other 	<p>Otter Field Signs</p> <ul style="list-style-type: none"> ● Feeding Signs ★ Footprints ◆ Unconfirmed Holt/Resting Place ● Other ■ Paths ⊕ Sightings ● Slides ■ Spraint
---	---	---

RCT: Riparian Camera Trap
CT: Camera Trap

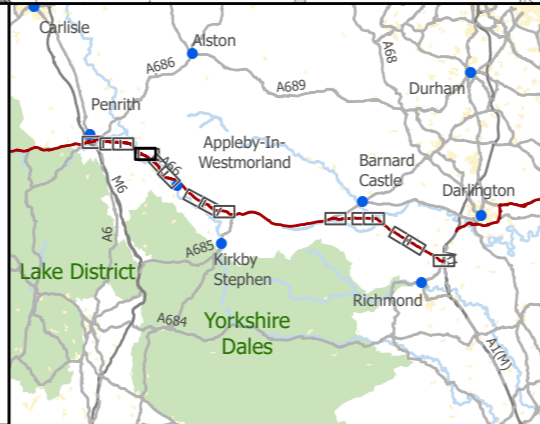

national highways | 3 Piccadilly Place | Manchester | M1 3BN

P02	First Issue				
	EREI	CESL	HWHI	AMIT	KWHA
	23/03/22	17/04/22	22/04/22	22/04/22	22/04/22
Revision	Created	Checked	Reviewed	Approved	Authorised

Kilometres
0 0.25 0.5

Scale @ A3: 1:10,000 | Project Ref No HE565627 | Stage: Stage 3
© Crown copyright and database rights (2022). All rights reserved. OS 100030649.
Contains public sector information licensed under the Open Government Licence v3.0.

Project Name A66 Northern Trans-Pennine Project			
Map Title Figure 6.16			
Scheme: 0405, Temple Sowerby to Appleby			
Sheet 4 of 15			
Map Number Project	Originator	Volume	
HE565627	AMY	EBD	
S00	MP	LB	003169
Location	Type	Role	Number
Suitability S4	Suitability Description FIT FOR STAGE APPROVAL		Revision P02

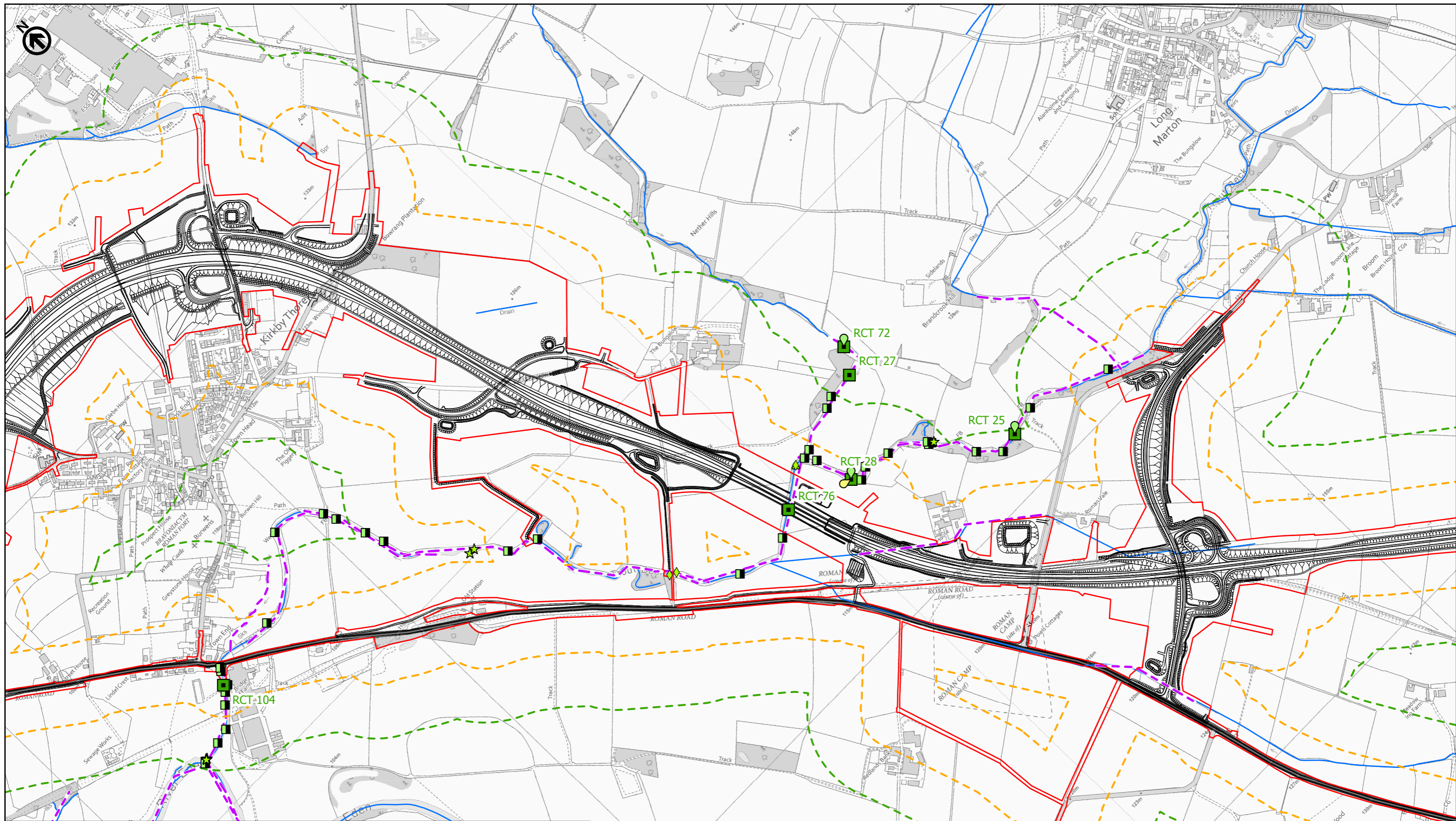

<ul style="list-style-type: none"> — Route Alignment — Existing A66 — Order Limits - - - Study Area 100m - - - Study Area 250m ■ Camera Trap — Watercourses - - - Mammal Riparian Walking Transect Routes 	<p>Camera Trap Sightings</p> <ul style="list-style-type: none"> ● Otter ● Otter Cubs ● Otter Holt <p>Incidental Records</p> <ul style="list-style-type: none"> ▲ Water Vole ▲ Otter <p>Water Vole Field Signs</p> <ul style="list-style-type: none"> ▲ Feeding Stations/Signs ● Other 	<p>Otter Field Signs</p> <ul style="list-style-type: none"> ■ Feeding Signs ★ Footprints ◆ Unconfirmed Holt/Resting Place ● Other ■ Paths + ● Sightings ● Slides ■ Spraint
---	---	--

RCT: Riparian Camera Trap
CT: Camera Trap

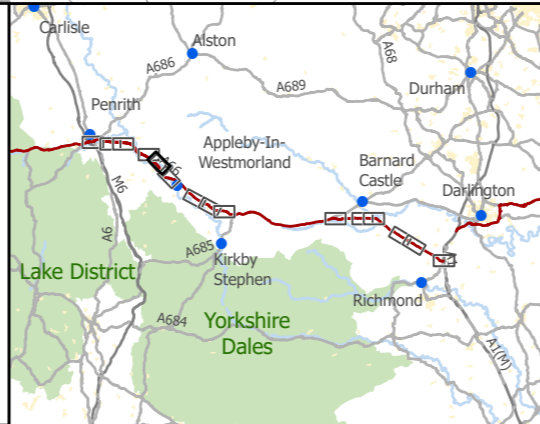

national highways

3 Piccadilly Place
Manchester
M1 3BN

P02	First Issue				
	EREI	CESL	HWHI	AMIT	KWHA
	23/03/22	17/04/22	22/04/22	22/04/22	22/04/22
Revision	Created	Checked	Reviewed	Approved	Authorised

Kilometres
0 0.25 0.5

Scale @ A3: 1:10,000 | Project Ref No HE565627 | Stage: Stage 3
© Crown copyright and database rights (2022). All rights reserved. OS 100030649.
Contains public sector information licensed under the Open Government Licence v3.0.

Project Name
A66 Northern Trans-Pennine Project

Map Title
Figure 6.16
Otter and Water Vole Survey
Scheme: 0405, Temple Sowerby to Appleby
Sheet 5 of 15

Map Number	Project	Originator	Volume
HE565627	-	AMY	- EBD
S00	-	MP	- LB - 003170
Location	Type	Role	Number
S4	FIT FOR STAGE APPROVAL		P02

Suitability S4 | Suitability Description FIT FOR STAGE APPROVAL | Revision P02

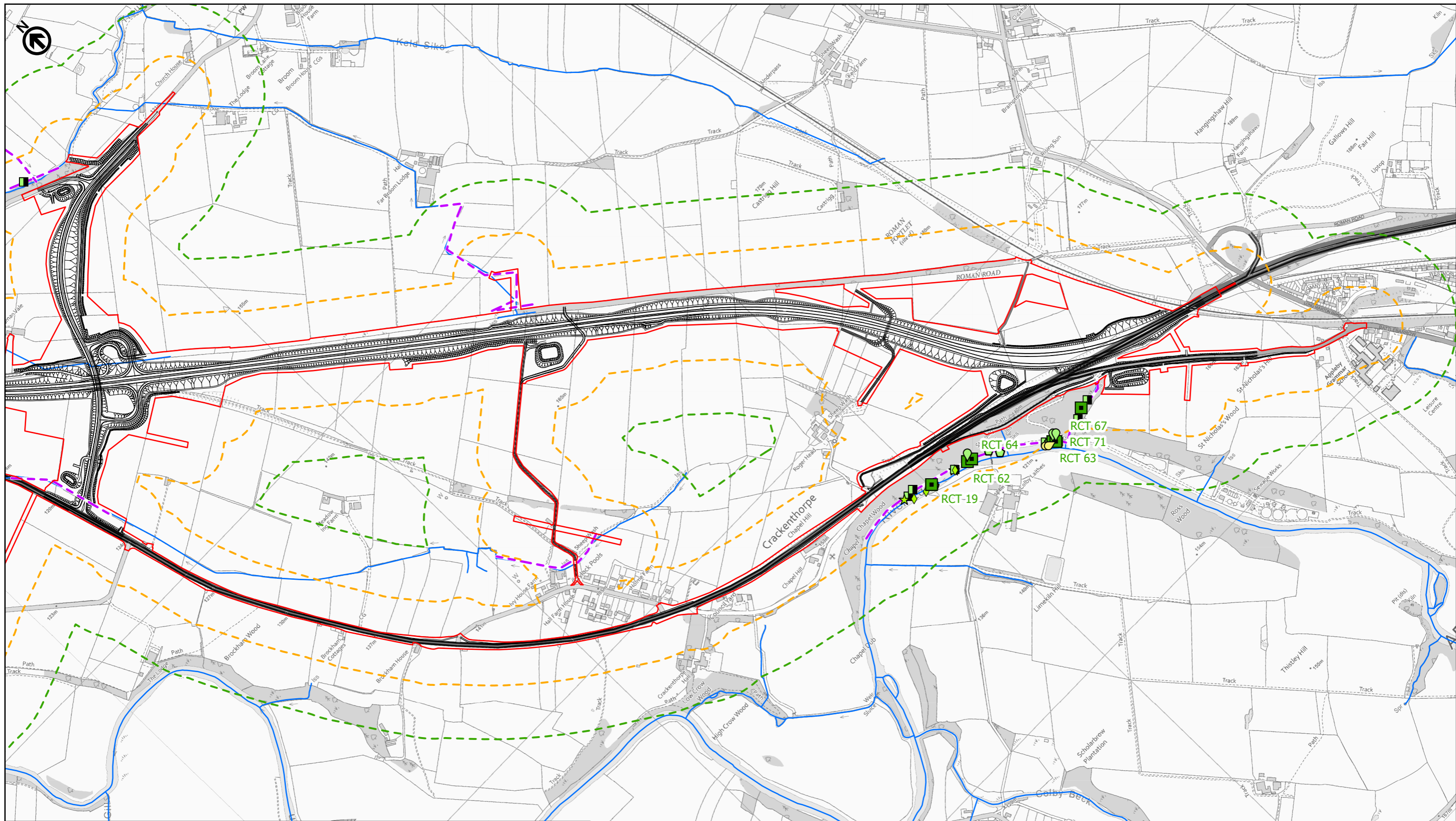

<ul style="list-style-type: none"> — Route Alignment — Existing A66 — Order Limits - - - Study Area 100m - - - Study Area 250m ■ Camera Trap — Watercourses - - - Mammal Riparian Walking Transect Routes 	<p>Camera Trap Sightings</p> <ul style="list-style-type: none"> ● Otter ● Otter Cubs ● Otter Holt <p>Incidental Records</p> <ul style="list-style-type: none"> ▲ Water Vole ▲ Otter <p>Water Vole Field Signs</p> <ul style="list-style-type: none"> ▲ Feeding Stations/Signs ● Other 	<p>Otter Field Signs</p> <ul style="list-style-type: none"> ▲ Feeding Signs ★ Footprints ◆ Unconfirmed Holt/Resting Place ● Other ■ Paths ⊕ Sightings ● Slides ■ Spraint
---	---	---

RCT: Riparian Camera Trap
CT: Camera Trap

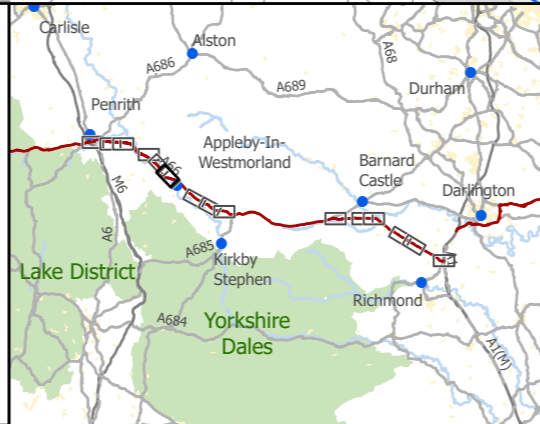

national highways

3 Piccadilly Place
Manchester
M1 3BN

P02	First Issue				
	EREI	CESL	HWHI	AMIT	KWHA
	23/03/22	17/04/22	22/04/22	22/04/22	22/04/22
Revision	Created	Checked	Reviewed	Approved	Authorised

Kilometres
0 0.25 0.5

Scale @ A3: 1:10,000 | Project Ref No HE565627 | Stage: Stage 3
© Crown copyright and database rights (2022). All rights reserved. OS 100030649.
Contains public sector information licensed under the Open Government Licence v3.0.

Project Name
A66 Northern Trans-Pennine Project

Map Title
Figure 6.16

Otter and Water Vole Survey

Scheme: 0405, Temple Sowerby to Appleby
Sheet 6 of 15

Map Number	Project	Originator	Volume
HE565627	-	AMY	- EBD
S00	-	MP	- LB - 003171
Location	Type	Role	Number
S4	FIT FOR STAGE APPROVAL		P02

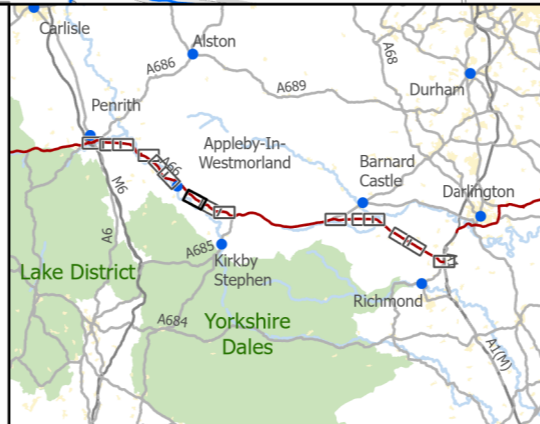
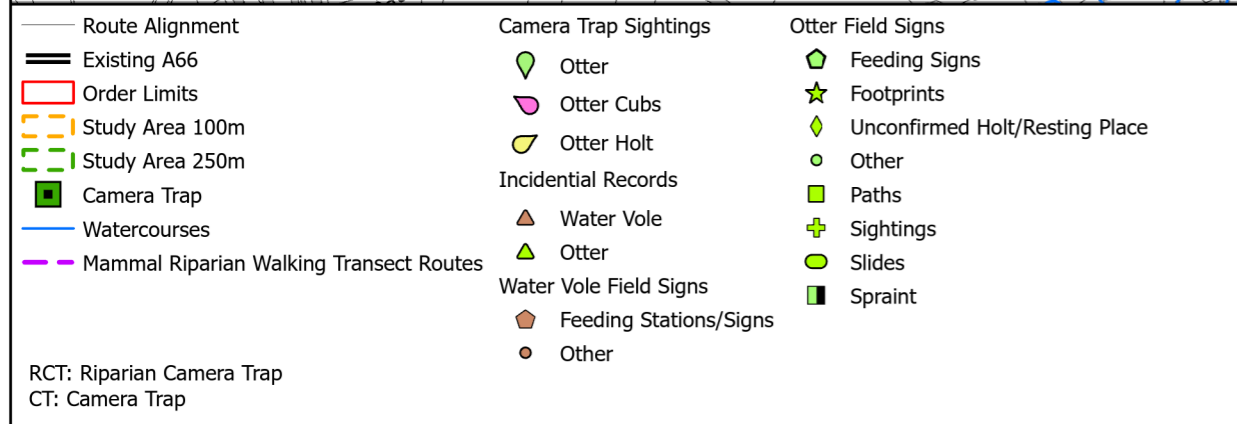
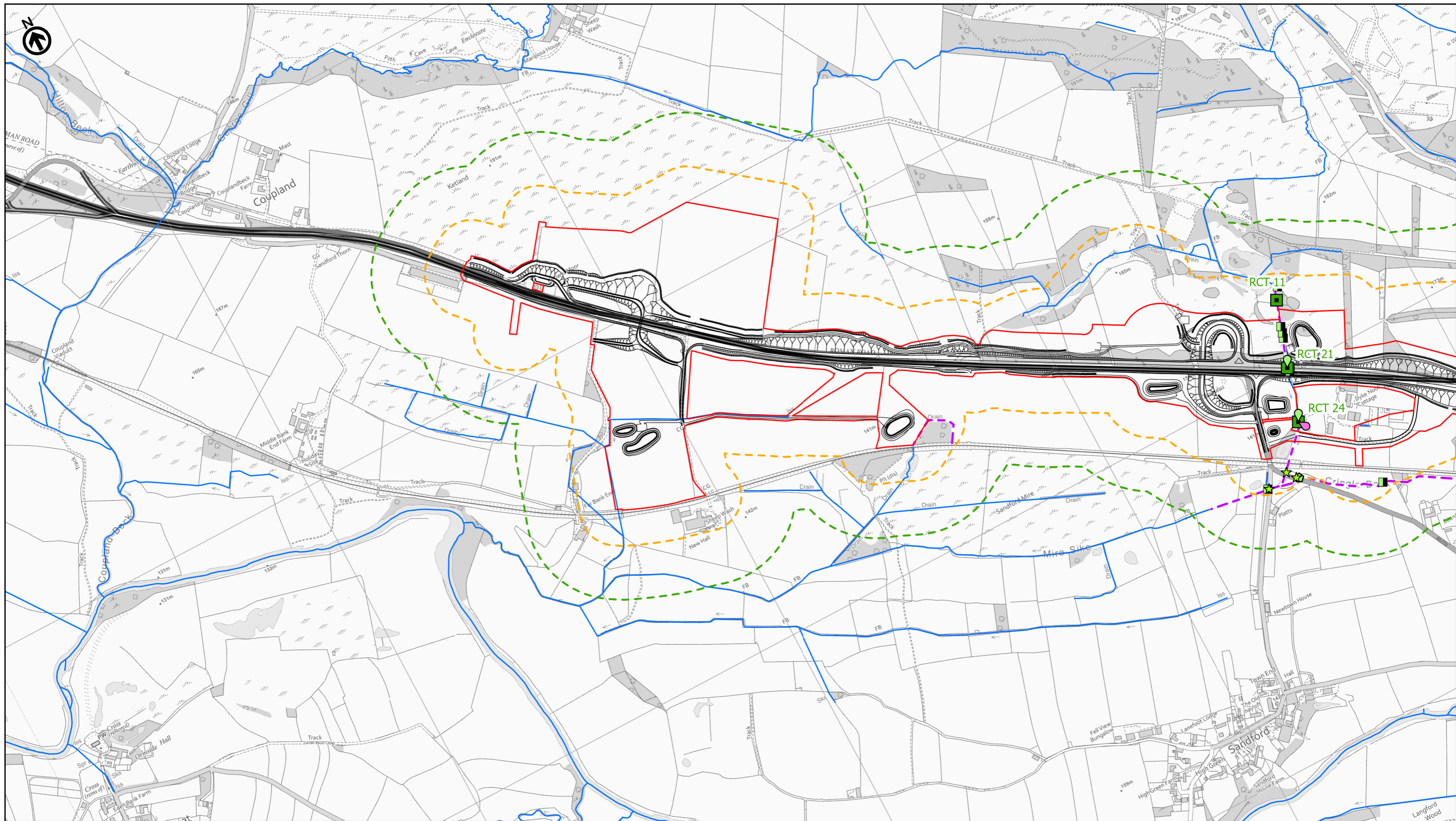

national highways

3 Piccadilly Place
Manchester
M1 3BN

P03	Second Issue: Revised Order Limits				
	KBIG	CESL	AMAR	AWAR	KWHA
	19/04/23	19/04/23	19/04/23	16/05/23	16/05/23
Revision	Created	Checked	Reviewed	Approved	Authorised

Kilometres
0 0.25 0.5

Scale @ A3: 1:10,000 | Project Ref No HE565627 | Stage: Stage 3
© Crown copyright and database rights (2023). All rights reserved. OS 100030649.
Contains public sector information licensed under the Open Government Licence v3.0.

Project Name A66 Northern Trans-Pennine Project			
Map Title Figure 6.16			
Scheme: 06, Appleby to Brough			
Sheet 7 of 15			
Map Number Project	Originator	Volume	
HE565627	AMY	EBD	
S00	MP	LB	003172
Location	Type	Role	Number
S4	FIT FOR STAGE APPROVAL		P03

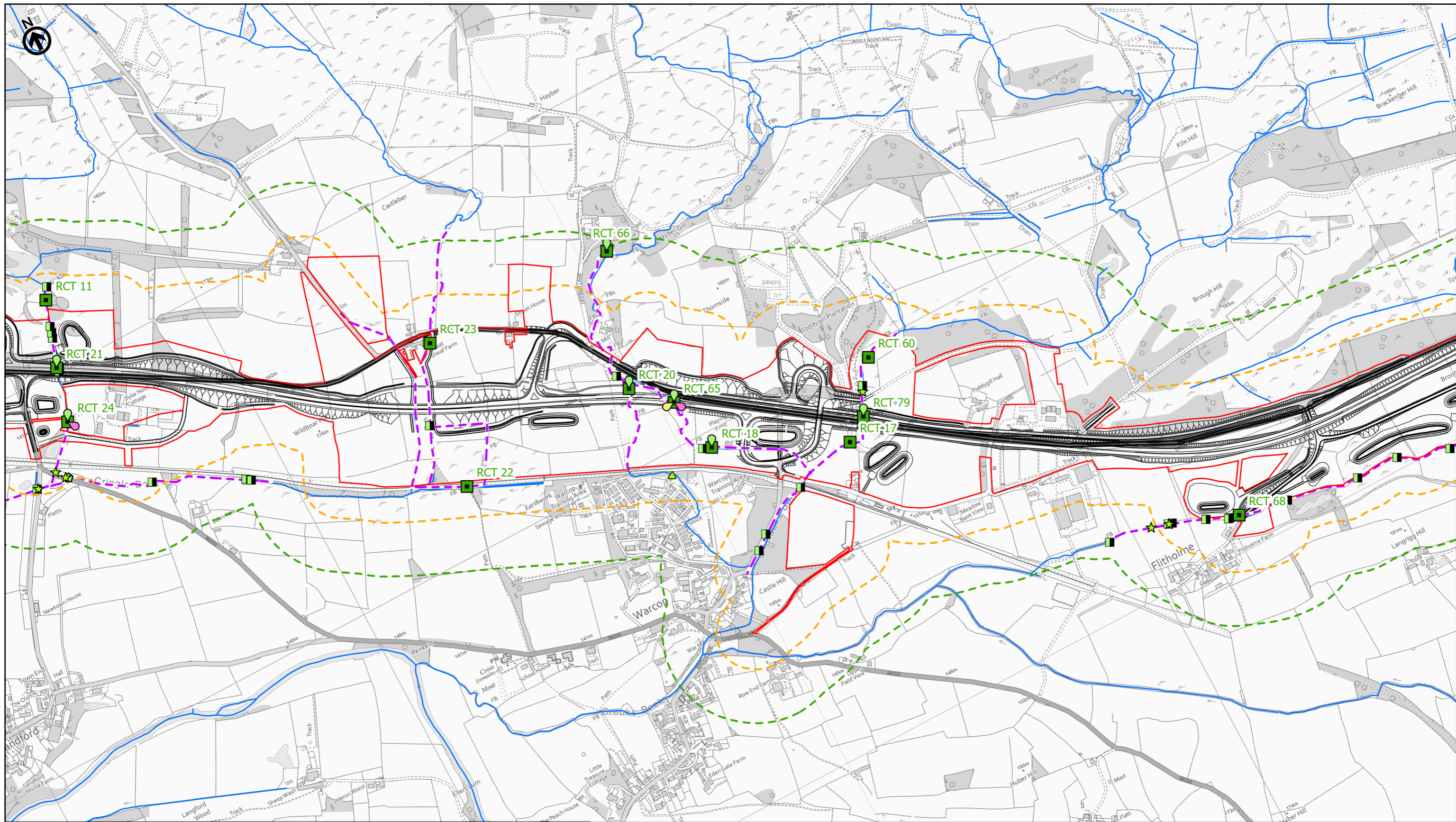

<ul style="list-style-type: none"> — Route Alignment — Existing A66 — Order Limits — Study Area 100m — Study Area 250m ■ Camera Trap — Watercourses — Mammal Riparian Walking Transect Routes 	<p>Camera Trap Sightings</p> <ul style="list-style-type: none"> ● Otter ● Otter Cubs ● Otter Holt <p>Incidental Records</p> <ul style="list-style-type: none"> ▲ Water Vole ▲ Otter <p>Water Vole Field Signs</p> <ul style="list-style-type: none"> ▲ Feeding Stations/Signs ● Other 	<p>Otter Field Signs</p> <ul style="list-style-type: none"> ■ Feeding Signs ★ Footprints ◆ Unconfirmed Holt/Resting Place ● Other ■ Paths ■ Sightings ■ Slides ■ Spraint
<p>RCT: Riparian Camera Trap CT: Camera Trap</p>		

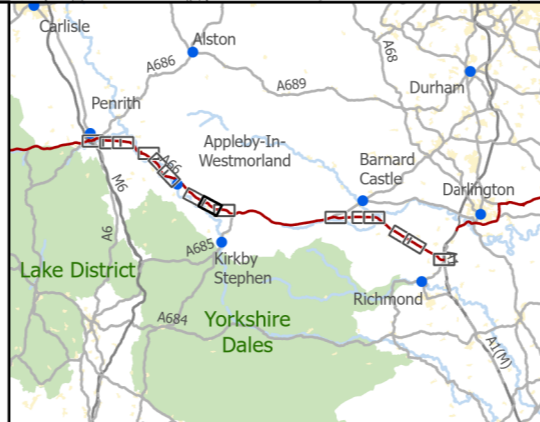

national highways

3 Piccadilly Place
Manchester
M1 3BN

P03	Second Issue: Revised Order Limits				
	KBIG	CESL	AMAR	AWAR	KWHA
	19/04/23	19/04/23	19/04/23	16/05/23	16/05/23
Revision	Created	Checked	Reviewed	Approved	Authorised

Kilometres
0 0.25 0.5

Scale @ A3: 1:10,000 | Project Ref No HE565627 | Stage: Stage 3
© Crown copyright and database rights (2023). All rights reserved. OS 100030649.
Contains public sector information licensed under the Open Government Licence v3.0.

Project Name
A66 Northern Trans-Pennine Project

Map Title
Figure 6.16

Otter and Water Vole Survey

Scheme: 06, Appleby to Brough

Sheet 8 of 15

Map Number	Project	Originator	Volume
HE565627	S00	AMY	EBD
Location	Type	Role	Number
S4	MP	LB	003173

Suitability Description
FIT FOR STAGE APPROVAL

Revision
P03

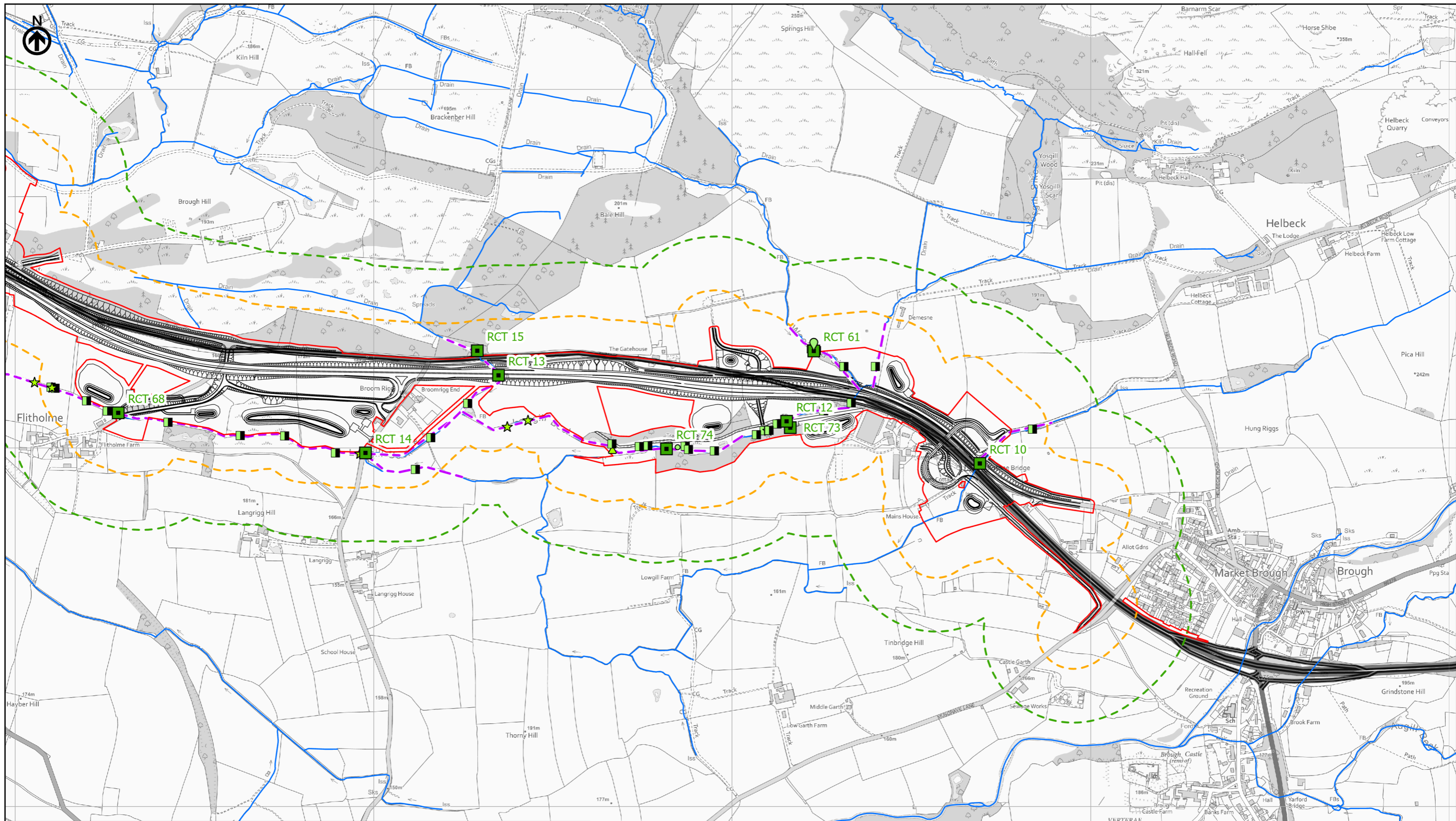

— Route Alignment
 — Existing A66
 — Order Limits
 — Study Area 100m
 — Study Area 250m
 ■ Camera Trap
 — Watercourses
 — Mammal Riparian Walking Transect Routes
 RCT: Riparian Camera Trap
 CT: Camera Trap

Camera Trap Sightings
 ● Otter
 ● Otter Cubs
 ● Otter Holt
 ● Incidental Records
 ● Water Vole
 ● Otter
 ● Water Vole Field Signs
 ● Feeding Stations/Signs
 ● Other

Otter Field Signs
 ● Feeding Signs
 ★ Footprints
 ◆ Unconfirmed Holt/Resting Place
 ● Other
 ■ Paths
 + Sightings
 ● Slides
 ■ Spraint



national highways
 3 Piccadilly Place
 Manchester
 M1 3BN

P03	Second Issue: Revised Order Limits				
	KBIG	CESL	AMAR	AWAR	KWHA
	19/04/23	19/04/23	19/04/23	16/05/23	16/05/23
Revision	Created	Checked	Reviewed	Approved	Authorised

Kilometres
 0 0.25 0.5

Scale @ A3: 1:10,000 | Project Ref No HE565627 | Stage: Stage 3
 © Crown copyright and database rights (2023). All rights reserved. OS 100030649.
 Contains public sector information licensed under the Open Government Licence v3.0.

Project Name
 A66 Northern Trans-Pennine Project

Map Title
 Figure 6.16
 Otter and Water Vole Survey
 Scheme: 06, Appleby to Brough
 Sheet 9 of 15

Map Number	Project	Originator	Volume
HE565627	-	AMY	EBD
S00	-	MP	LB
Location	-	Type	Role
S4	FIT FOR STAGE APPROVAL		Number
			P03

Suitability
 S4

Suitability Description
 FIT FOR STAGE APPROVAL

Revision
 P03

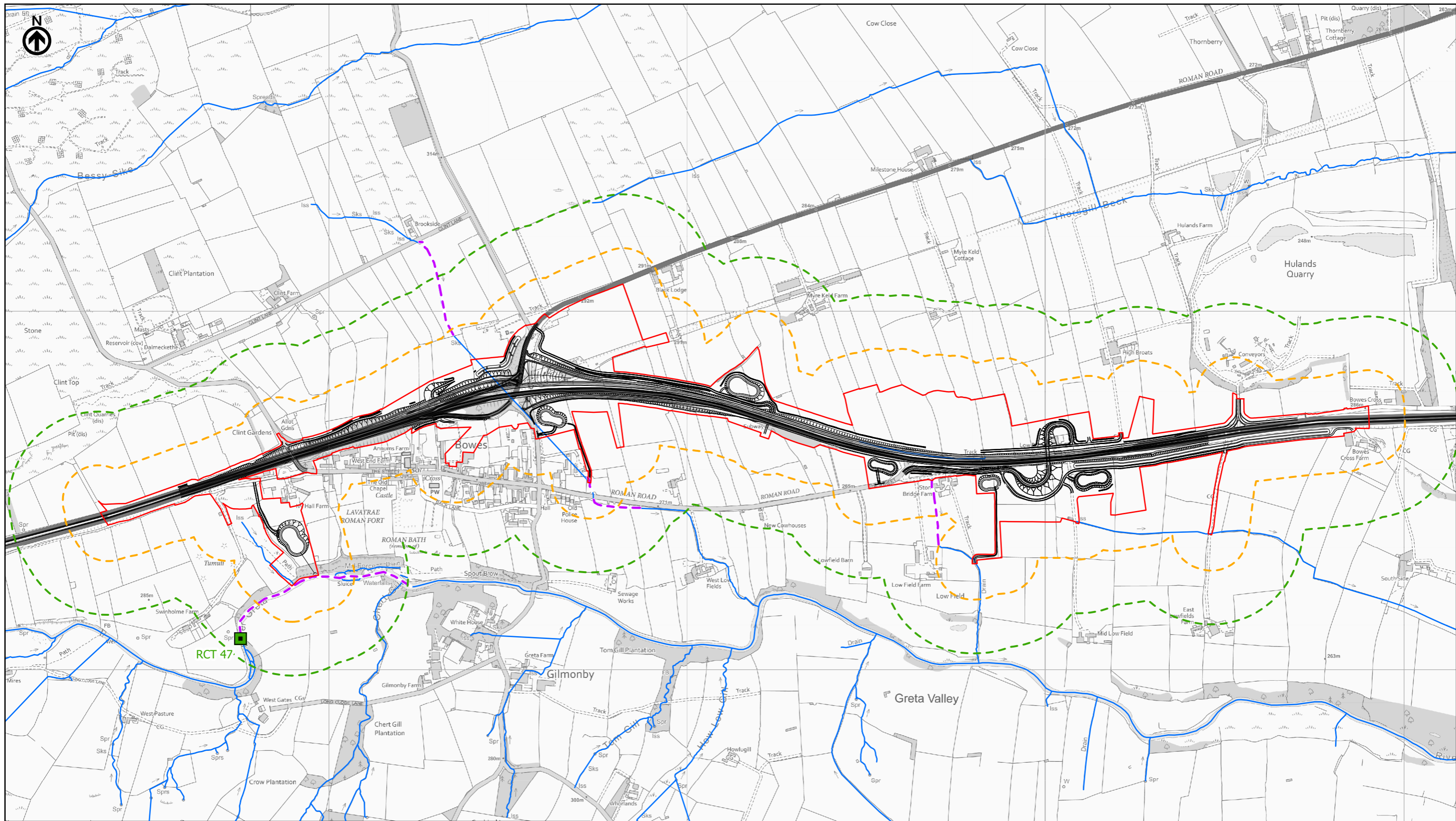

<ul style="list-style-type: none"> — Route Alignment — Existing A66 — Order Limits — Study Area 100m — Study Area 250m ■ Camera Trap — Watercourses — Mammal Riparian Walking Transect Routes 	<p>Camera Trap Sightings</p> <ul style="list-style-type: none"> ● Otter ● Otter Cubs ● Otter Holt <p>Incidental Records</p> <ul style="list-style-type: none"> ▲ Water Vole ▲ Otter <p>Water Vole Field Signs</p> <ul style="list-style-type: none"> ▲ Feeding Stations/Signs ● Other 	<p>Otter Field Signs</p> <ul style="list-style-type: none"> ● Feeding Signs ★ Footprints ◆ Unconfirmed Holt/Resting Place ● Other ■ Paths ■ Sightings ■ Slides ■ Spraint
---	---	---

RCT: Riparian Camera Trap
CT: Camera Trap

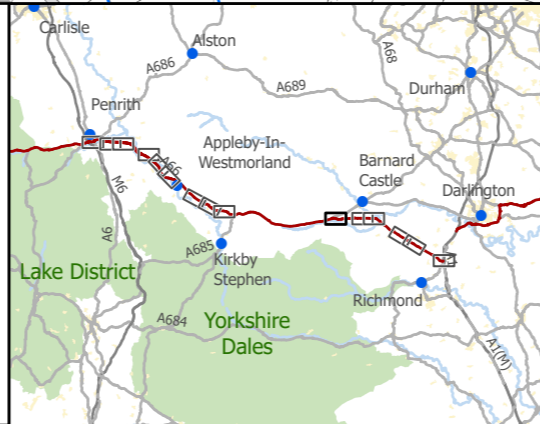

national highways

3 Piccadilly Place
Manchester
M1 3BN

P02	First Issue				
	EREI	CESL	HWHI	AMIT	KWHA
	23/03/22	17/04/22	22/04/22	22/04/22	22/04/22
Revision	Created	Checked	Reviewed	Approved	Authorised

Kilometres

0 0.25 0.5

Scale @ A3: 1:10,000 | Project Ref No HE565627 | Stage: Stage 3
© Crown copyright and database rights (2022). All rights reserved. OS 100030649.
Contains public sector information licensed under the Open Government Licence v3.0.

Project Name
A66 Northern Trans-Pennine Project

Map Title
Figure 6.16

Otter and Water Vole Survey

Scheme: 07, Bowes Bypass

Sheet 10 of 15

Map Number	Project	Originator	Volume
HE565627	-	AMY	- EBD
S00	-	MP	- LB - 003175
Location	Type	Role	Number
S4	FIT FOR STAGE APPROVAL		P02

Suitability S4 | Suitability Description FIT FOR STAGE APPROVAL | Revision P02

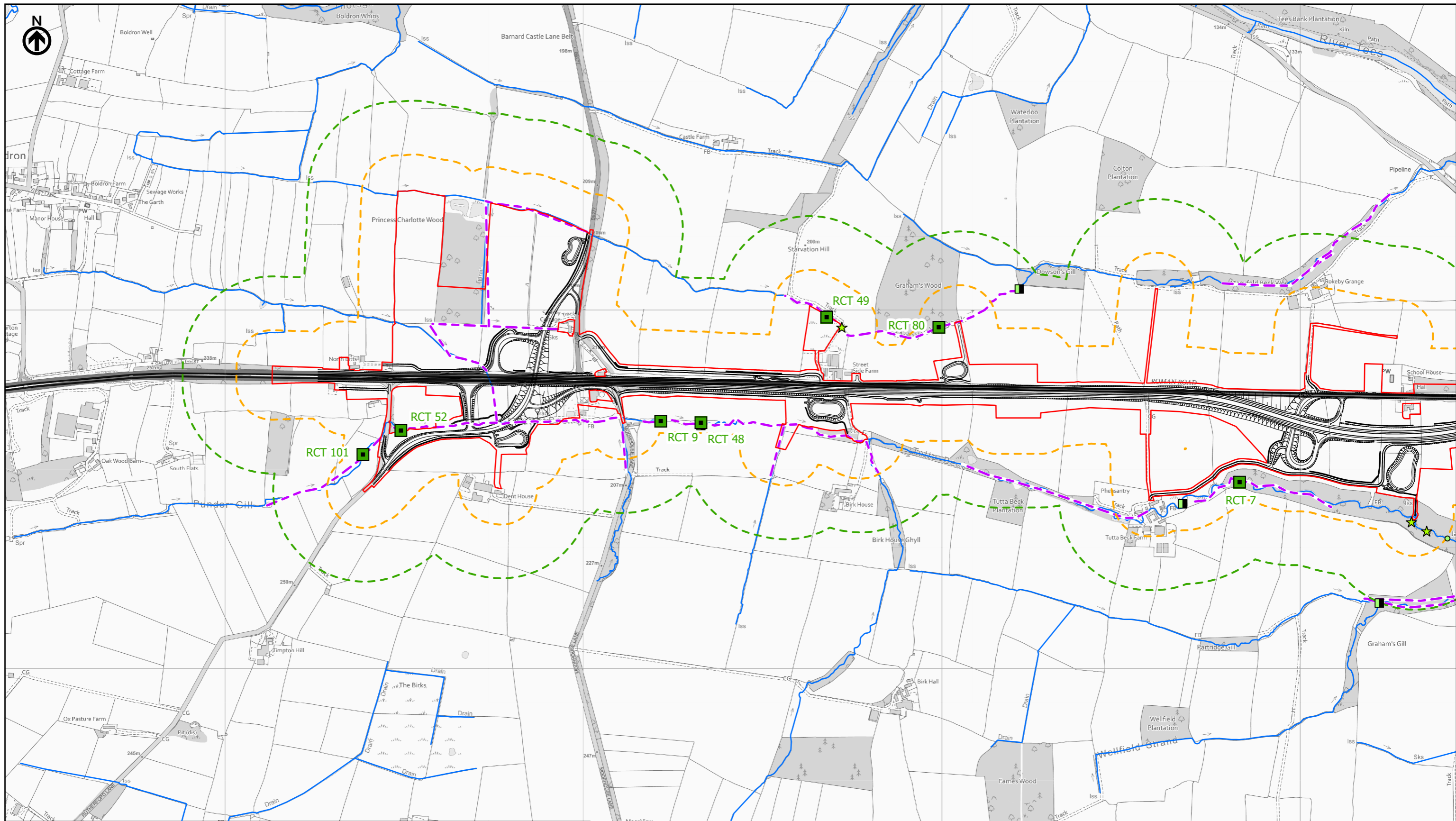

<ul style="list-style-type: none"> — Route Alignment — Existing A66 — Order Limits — Study Area 100m — Study Area 250m ■ Camera Trap — Watercourses — Mammal Riparian Walking Transect Routes 	<p>Camera Trap Sightings</p> <ul style="list-style-type: none"> ● Otter ● Otter Cubs ● Otter Holt <p>Incidental Records</p> <ul style="list-style-type: none"> ▲ Water Vole ▲ Otter <p>Water Vole Field Signs</p> <ul style="list-style-type: none"> ▲ Feeding Stations/Signs ● Other 	<p>Otter Field Signs</p> <ul style="list-style-type: none"> ■ Feeding Signs ★ Footprints ◆ Unconfirmed Holt/Resting Place ● Other ■ Paths ⊕ Sightings ● Slides ■ Spraint
---	---	---

RCT: Riparian Camera Trap
CT: Camera Trap



national highways	3 Piccadilly Place Manchester M1 3BN						
	P02	First Issue	EREI	CESL	HWHI	AMIT	KWHA
	23/03/22	17/04/22	22/04/22	22/04/22	22/04/22	22/04/22	22/04/22
Revision	Created	Checked	Reviewed	Approved	Authorised		
Kilometres							
0 0.25 0.5							
Scale @ A3: 1:10,000 Project Ref No HE565627 Stage: Stage 3							
© Crown copyright and database rights (2022). All rights reserved. OS 100030649. Contains public sector information licensed under the Open Government Licence v3.0.							

Project Name A66 Northern Trans-Pennine Project			
Map Title Figure 6.16			
Scheme: 08, Cross Lanes to Rokeby			
Sheet 11 of 15			
Map Number Project	Originator	Volume	
HE565627	AMY	EBD	
S00		MP	LB - 003176
Location		Type	Role Number
Suitability S4	Suitability Description FIT FOR STAGE APPROVAL		Revision P02

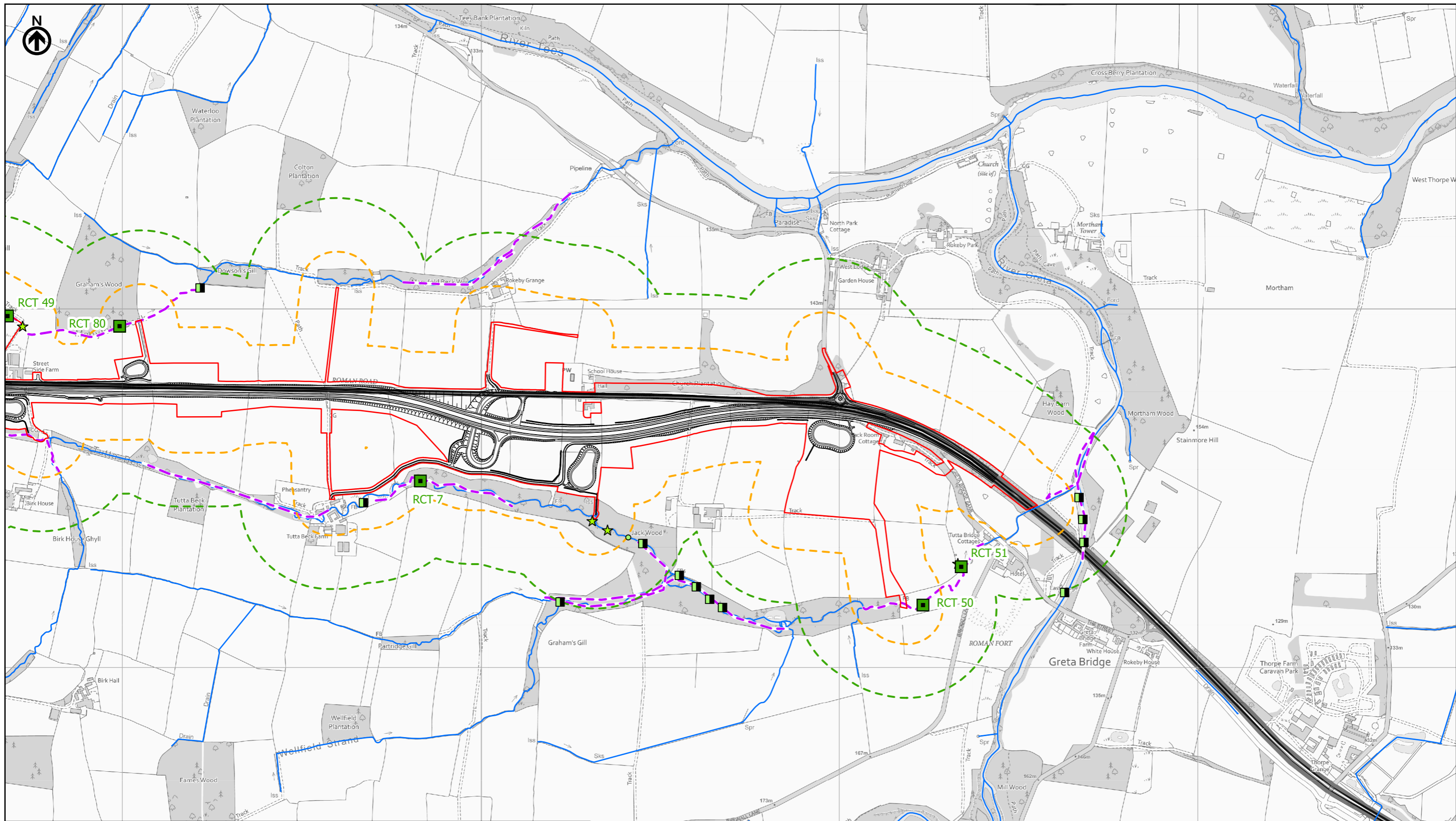

<ul style="list-style-type: none"> — Route Alignment — Existing A66 — Order Limits — Study Area 100m — Study Area 250m ■ Camera Trap — Watercourses — Mammal Riparian Walking Transect Routes 	<p>Camera Trap Sightings</p> <ul style="list-style-type: none"> ● Otter ● Otter Cubs ● Otter Holt <p>Incidental Records</p> <ul style="list-style-type: none"> ▲ Water Vole ▲ Otter <p>Water Vole Field Signs</p> <ul style="list-style-type: none"> ▲ Feeding Stations/Signs ● Other 	<p>Otter Field Signs</p> <ul style="list-style-type: none"> ■ Feeding Signs ★ Footprints ◆ Unconfirmed Holt/Resting Place ● Other ■ Paths ■ Sightings ■ Slides ■ Spraint
---	---	---

RCT: Riparian Camera Trap
CT: Camera Trap



	<p>3 Piccadilly Place Manchester M1 3BN</p>																												
	<p>Scale @ A3: 1:10,000 Project Ref No HE565627 Stage: Stage 3 © Crown copyright and database rights (2022). All rights reserved. OS 100030649. Contains public sector information licensed under the Open Government Licence v3.0.</p>																												
<table border="1"> <thead> <tr> <th colspan="6">First Issue</th> </tr> <tr> <th>P02</th> <th>EREI</th> <th>CESL</th> <th>HWHI</th> <th>AMIT</th> <th>KWHA</th> </tr> </thead> <tbody> <tr> <td></td> <td>23/03/22</td> <td>17/04/22</td> <td>22/04/22</td> <td>22/04/22</td> <td>22/04/22</td> </tr> <tr> <th>Revision</th> <th>Created</th> <th>Checked</th> <th>Reviewed</th> <th>Approved</th> <th>Authorised</th> </tr> </tbody> </table>	First Issue						P02	EREI	CESL	HWHI	AMIT	KWHA		23/03/22	17/04/22	22/04/22	22/04/22	22/04/22	Revision	Created	Checked	Reviewed	Approved	Authorised	<p>Kilometres</p> <p>0 0.25 0.5</p>				
First Issue																													
P02	EREI	CESL	HWHI	AMIT	KWHA																								
	23/03/22	17/04/22	22/04/22	22/04/22	22/04/22																								
Revision	Created	Checked	Reviewed	Approved	Authorised																								

Project Name				A66 Northern Trans-Pennine Project			
Map Title				Figure 6.16			
Scheme: 08, Cross Lanes to Rokeby				Sheet 12 of 15			
Map Number	Project	Originator	Volume				
HE565627	-	AMY	-	EBD			
S00		- MP - LB - 003179					
Location		Type	Role				
Suitability	Suitability Description			Revision			
S4	FIT FOR STAGE APPROVAL			P02			

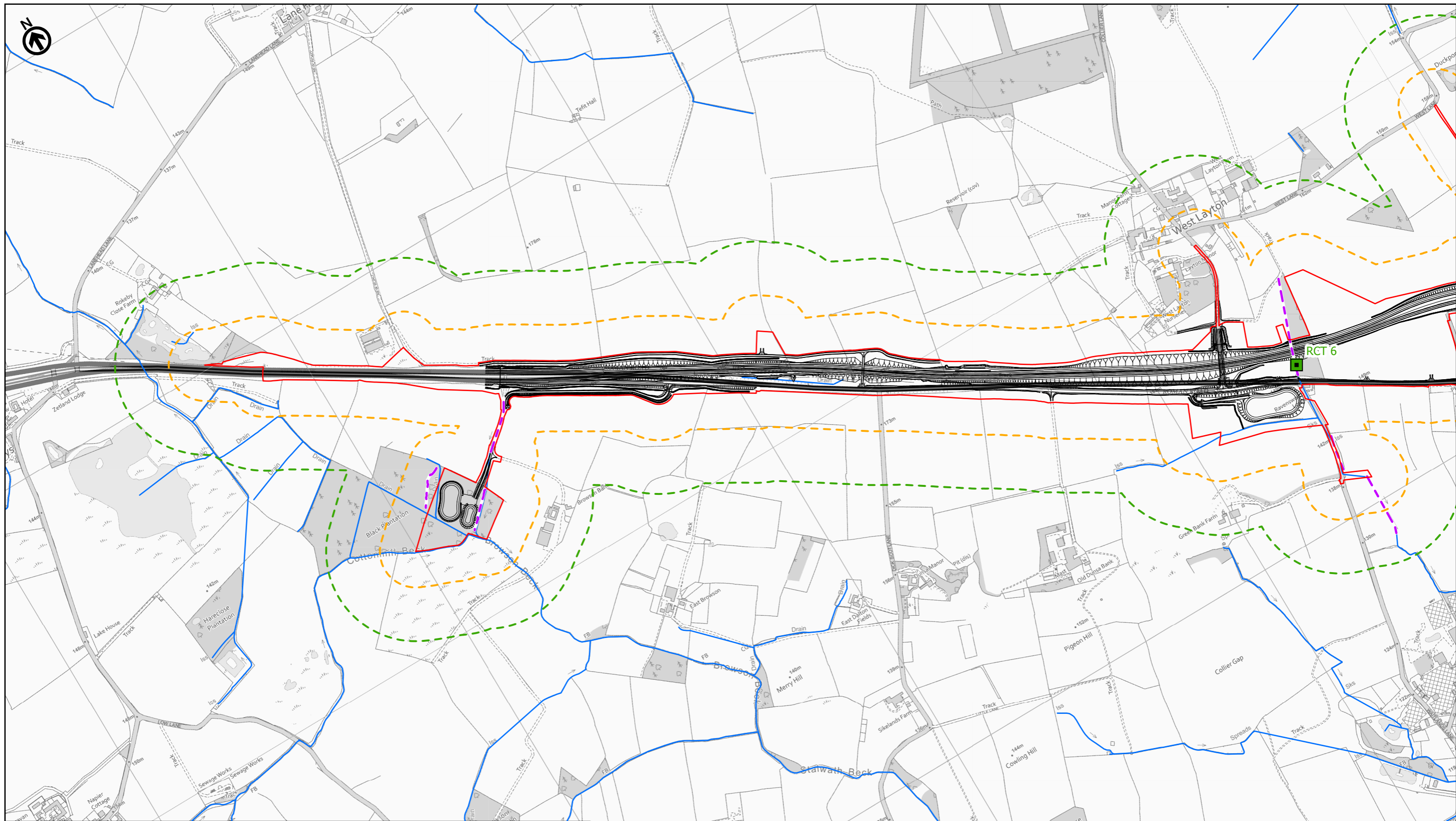

<ul style="list-style-type: none"> — Route Alignment — Existing A66 — Order Limits — Study Area 100m — Study Area 250m ■ Camera Trap — Watercourses — Mammal Riparian Walking Transect Routes 	<p>Camera Trap Sightings</p> <ul style="list-style-type: none"> ● Otter ● Otter Cubs ● Otter Holt <p>Incidental Records</p> <ul style="list-style-type: none"> ▲ Water Vole ▲ Otter <p>Water Vole Field Signs</p> <ul style="list-style-type: none"> ● Feeding Stations/Signs ● Other 	<p>Otter Field Signs</p> <ul style="list-style-type: none"> ● Feeding Signs ★ Footprints ◆ Unconfirmed Holt/Resting Place ● Other ■ Paths ■ Sightings ■ Slides ■ Spraint
---	---	---

RCT: Riparian Camera Trap
CT: Camera Trap

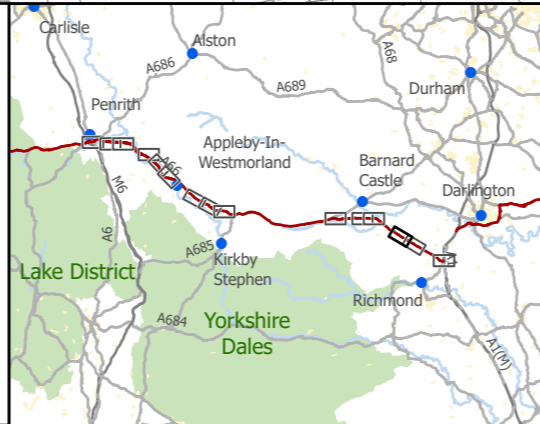

national highways

3 Piccadilly Place
Manchester
M1 3BN

P02	First Issue				
	EREI	CESL	HWHI	AMIT	KWHA
	23/03/22	17/04/22	22/04/22	22/04/22	22/04/22
Revision	Created	Checked	Reviewed	Approved	Authorised

Kilometres

0 0.25 0.5

Scale @ A3: 1:10,000 | Project Ref No HE565627 | Stage: Stage 3
© Crown copyright and database rights (2022). All rights reserved. OS 100030649.
Contains public sector information licensed under the Open Government Licence v3.0.

Project Name A66 Northern Trans-Pennine Project			
Map Title Figure 6.16			
Scheme: 09, Stephen Bank to Carkin Moor			
Sheet 13 of 15			
Map Number Project	Originator	Volume	
HE565627	AMY	EBD	
Location		Type	Role
S00		MP	LB
S4		003177	
Suitability	Suitability Description		Revision
S4	FIT FOR STAGE APPROVAL		P02

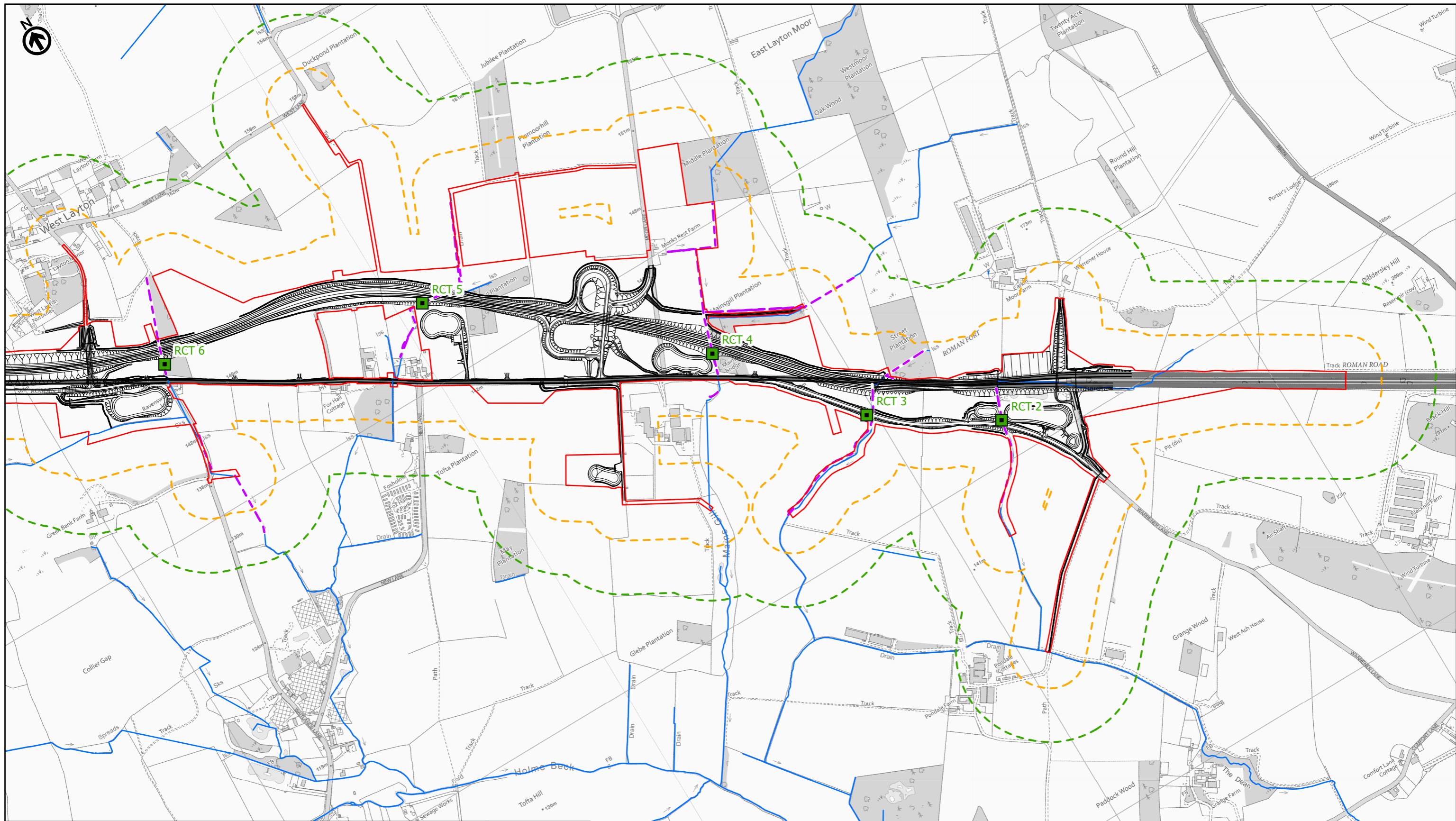

<ul style="list-style-type: none"> — Route Alignment — Existing A66 — Order Limits — Study Area 100m — Study Area 250m ■ Camera Trap — Watercourses — Mammal Riparian Walking Transect Routes 	<p>Camera Trap Sightings</p> <ul style="list-style-type: none"> ● Otter ● Otter Cubs ● Otter Holt <p>Incidental Records</p> <ul style="list-style-type: none"> ▲ Water Vole ▲ Otter <p>Water Vole Field Signs</p> <ul style="list-style-type: none"> ● Feeding Stations/Signs ● Other 	<p>Otter Field Signs</p> <ul style="list-style-type: none"> ● Feeding Signs ★ Footprints ◆ Unconfirmed Holt/Resting Place ● Other ■ Paths ⊕ Sightings ● Slides ■ Spraint
---	---	---

RCT: Riparian Camera Trap
CT: Camera Trap

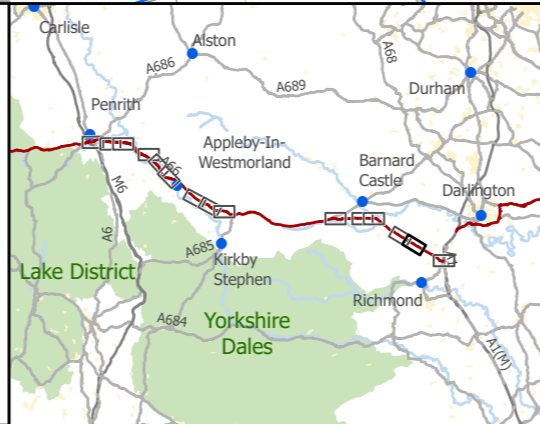

national highways

3 Piccadilly Place
Manchester
M1 3BN

P02	First Issue				
	EREI	CESL	HWHI	AMIT	KWHA
	23/03/22	17/04/22	22/04/22	22/04/22	22/04/22
Revision	Created	Checked	Reviewed	Approved	Authorised

Kilometres
0 0.25 0.5

Scale @ A3: 1:10,000 | Project Ref No HE565627 | Stage: Stage 3
© Crown copyright and database rights (2022). All rights reserved. OS 100030649.
Contains public sector information licensed under the Open Government Licence v3.0.

Project Name
A66 Northern Trans-Pennine Project

Map Title
Figure 6.16

Otter and Water Vole Survey

Scheme: 09, Stephen Bank to Carkin Moor
Sheet 14 of 15

Map Number	Project	Originator	Volume
HE565627	-	AMY	-
S00	-	MP	-
Location	Type	Role	Number
S4	FIT FOR STAGE APPROVAL		P02

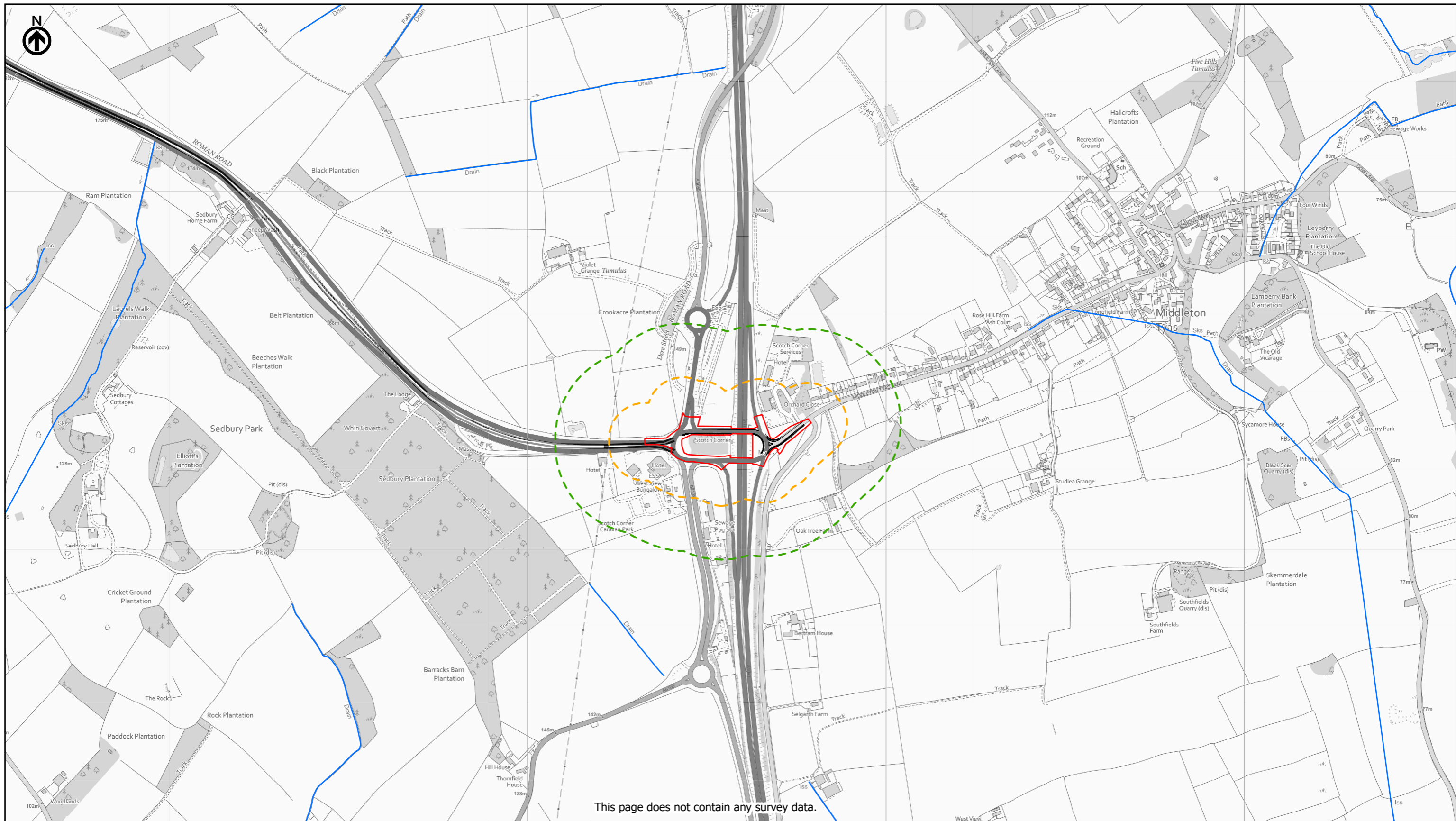

This page does not contain any survey data.

<ul style="list-style-type: none"> — Route Alignment — Existing A66 — Order Limits — Study Area 100m — Study Area 250m ■ Camera Trap — Watercourses — Mammal Riparian Walking Transect Routes 	<p>Camera Trap Sightings</p> <ul style="list-style-type: none"> ● Otter ● Otter Cubs ● Otter Holt <p>Incidental Records</p> <ul style="list-style-type: none"> ▲ Water Vole ▲ Otter <p>Water Vole Field Signs</p> <ul style="list-style-type: none"> ● Feeding Stations/Signs ● Other 	<p>Otter Field Signs</p> <ul style="list-style-type: none"> ● Feeding Signs ★ Footprints ◆ Unconfirmed Holt/Resting Place ● Other ■ Paths ⊕ Sightings ● Slides ■ Spraint
---	---	---

RCT: Riparian Camera Trap
CT: Camera Trap

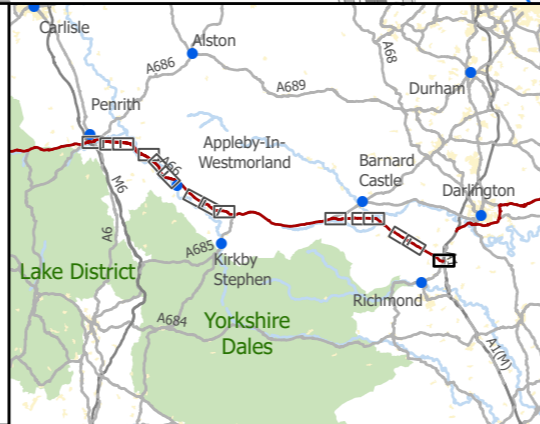

national highways

3 Piccadilly Place
Manchester
M1 3BN

P02	First Issue				
	EREI	CESL	HWHI	AMIT	KWHA
	23/03/22	17/04/22	22/04/22	22/04/22	22/04/22
Revision	Created	Checked	Reviewed	Approved	Authorised

Kilometres
0 0.25 0.5

Scale @ A3: 1:10,000 | Project Ref No HE565627 | Stage: Stage 3
© Crown copyright and database rights (2022). All rights reserved. OS 100030649.
Contains public sector information licensed under the Open Government Licence v3.0.

Project Name
A66 Northern Trans-Pennine Project

Map Title
Figure 6.16
Otter and Water Vole Survey

Scheme: 11, A1(M) Junction 53 Scotch Corner
Sheet 15 of 15

Map Number	Project	Originator	Volume
HE565627	-	AMY	- EBD
S00	-	MP	- LB - 003166
Location	Type	Role	Number
S4	FIT FOR STAGE APPROVAL		P02